



# Grip-Master FIXTURE LOCKS

## PRICES OF FIXTURE LOCKS WITH SPECIAL BAR LENGTHS

|     | 2-FL    | 2-PA   |
|-----|---------|--------|
| 10" | \$83.49 | 101.64 |
| 12" | 85.91   | 106.48 |
| 14" | 87.12   | 106.48 |
| 16" | 84.70   | 110.11 |
| 18" | 93.17   | 112.53 |
| 20" | 95.59   | 116.16 |
| 24" | 98.01   | 118.58 |

|     | 9-FL   | 9-PA   |
|-----|--------|--------|
| 12" | 104.06 | 127.05 |
| 14" | 106.48 | 124.63 |
| 16" | 110.11 | 134.31 |
| 18" | 112.53 | 136.73 |
| 20" | 116.16 | 140.36 |
| 24" | 118.58 | 142.78 |

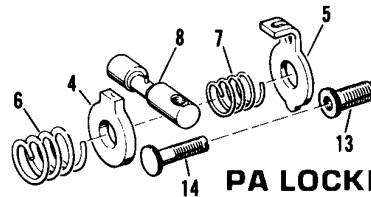
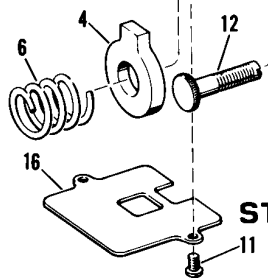
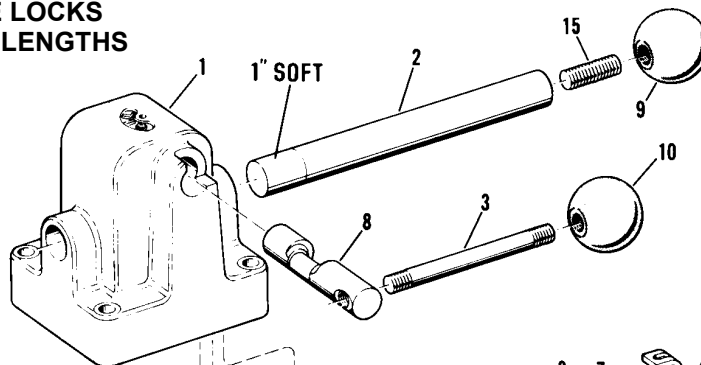

**PA LOCKING MECHANISM**

**STANDARD LOCKING MECHANISM**

| Index No. | Part Name   | MODEL NUMBER   |         |                |         |
|-----------|---|----------------|---------|----------------|---------|
|           |   | 2-FL<br>2-PA** |         | 9-FL<br>9-PA** |         |
|           |   | Part No.       | Price   | Part No.       | Price   |
| 1         | Body Casting (Note 1)                               | 2-FL           | --      | 9-FL           | --      |
| 2         | Bar, Locking, Standard                              | 213-9"         | \$19.66 | 913-10"        | \$27.99 |
| 2         | Bar, Special  | 213-10"        | 21.94   | --             | --      |
| 2         | Bar, Special  | 213-12"        | 26.47   | 913-12"        | 38.57   |
| 2         | Bar, Special  | 213-14"        | 27.99   | 913-14"        | 44.62   |
| 2         | Bar, Special  | 213-16"        | 33.28   | 913-16"        | 49.91   |
| 2         | Bar, Special  | 213-18"        | 39.33   | 913-18"        | 55.96   |
| 2         | Bar, Special  | 213-20"        | 44.62   | 913-20"        | 61.26   |
| 2         | Bar, Special  | 213-24"        | 50.67   | 913-24"        | 67.31   |
| 3         | Handle  | GM-3415        | 3.63    | 6815           | 5.66    |
| 4         | Locking Ring  | SV-3416        | 23.23   | SV-6816        | 30.49   |
| 5         | Holding Ring  | PA-3416**      | 18.88   | PA-6816**      | 27.59   |
| 6         | Spring, Locking                                     | GM-417         | 8.71    | 6817           | 10.16   |
| 7         | Spring, Holding                                     | PA-3417**      | 11.62   | PA-6817**      | 8.71    |
| 8         | Crank   | GM-3418        | 15.97   | GM-6818        | 30.49   |
| 8         | Crank, with 1/8" Pin                                | GMPA-3418*     | 21.05   | GMPA-6818**    | 31.94   |
| 9         | Knob, Black -- 1" Dia., 1/4-20 thread               | SV-3421        | 3.34    | --             | --      |
| 9         | Knob, Red -- 1" Dia., 1/4-20 thread                 | RSV-3421**     | 3.48    | --             | --      |
| 9         | Knob, Black -- 1 1/2" Dia., 3/8-24 thread           | --             | --      | SV-6821        | 3.48    |
| 9         | Knob, Red -- 1 1/2" Dia., 3/8-24 thread             | --             | --      | RSV-6821**     | 6.97    |
| 10        | Knob, Black -- 1 1/8" x 1 7/16" oval, 3/8-16 thread | OA-3421        | 3.48    | --             | --      |
| 10        | Knob, Red -- 1 1/8" x 1 7/16" oval, 3/8-16 thread   | ROA-3421**     | 6.10    | --             | --      |
| 10        | Knob, Black -- 1 1/2" Dia., 3/8-24 thread           | --             | --      | SV-6821        | 3.48    |
| 10        | Knob, Red -- 1 1/2" Dia., 3/8-24 thread             | --             | --      | RSV-6821**     | 6.97    |
| 12        | Screw   | SV-31          | 7.26    | SV-31          | 7.26    |
| 13        | Adjusting Screw -- Female                           | PA-32**        | 8.71    | PA-32**        | 8.71    |
| 14        | Adjusting Screw -- Male                             | PA-33**        | 8.71    | PA-33**        | 8.71    |
| 15        | Stud  | 3423           | 1.89    | 6823           | 2.03    |
| 16        | Cover Plate   | 3437           | 3.12    | 6837           | 5.30    |

Recommended spare part to be retained in stock at all times to support each unit: Index (4) locking ring, Index (2) bar.  
SEE OPERATION AND MAINTENANCE INSTRUCTIONS FOR GRIP-MASTER VISES ON THE GRIP-MASTER VISES PAGE

**WHEN ORDERING PARTS, INDICATE PART NUMBER, MODEL NUMBER AND PRICE.**