

# heinrich AIR ACCESSORIES ... single-acting

## NO. 34 THREE-WAY AIR VALVE ASSEMBLY -

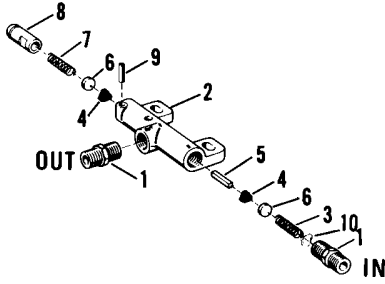

## NO. 34-12CI THREE-WAY FOOT TREADLE VALVE ASSEMBLY -

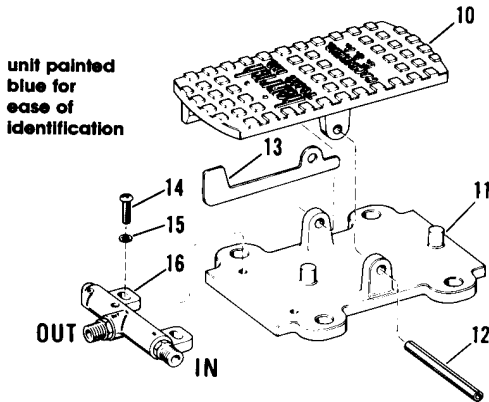

## NO. 34-18 THREE-WAY HAND OPERATED VALVE ASSEMBLY -

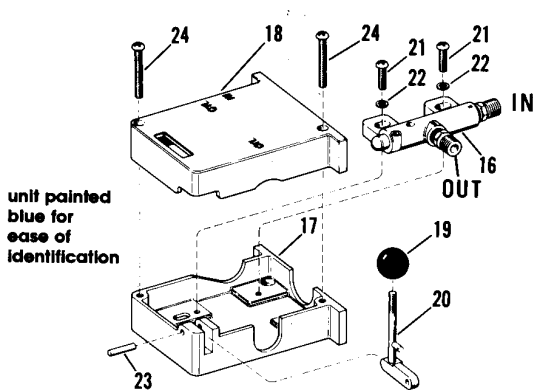

### MAINTENANCE:

If the No. 34 Three-Way Air Valve becomes inoperable, disassemble, clean and check each part for wear or damage, especially the seats in the valve body. Replacement parts are available for immediate shipment from factory stock, or you may order through your local Heinrich distributor. When re-assembling, all parts must be placed in the order as shown in the exploded view.

### OPERATION:

Slotted mounting holes are provided in the valve body so that the position of the valve on the foot or hand base may be adjusted. The valve should be so positioned that air does not escape in either open or closed position. This can be determined by the sound of air escaping. Mounting screws should be securely fastened after adjustment.

The plunger (8) on the valve should be greased occasionally.

Index No.	Part Name	Part No.	Price
1	Adapter (2 required)	33-16	\$3.61
2	Valve Body	34-2	20.51
3	Inlet Spring (light)	34-3	1.56
4	Poppet (2 required)	34-4	1.64
5	Brass Pin	34-5	1.64
6	Brass Slug for Backing Poppet (2 required)	34-6	0.98
7	Outlet Plunger Spring (heavy)	34-7	3.28
8	Plunger	45-8	3.94
9	1/8 x 3/4 Rollpin	34-9	1.31
10	Retaining Ring	34-10	0.66

REPAIR KIT FOR NO. 34 AIR VALVE ASSEMBLY, CONSISTING OF INDEX NUMBERS 3 thru 10 RK-34 \$10.53

It is recommended that a repair kit be retained in stock at all times to support the valve in service. The kit price represents a 22% savings off the individual piece prices.

10	Foot Treadle Casting -- Top	34-15	\$34.18
11	Foot Treadle Casting -- Bottom	34-16	32.47
12	5/16 x 3 1/4 Rollpin	34-11	1.89
13	Wear Strip	34-17	4.92
14	10-32 x 5/8 Screw (2 required)	34-13	1.15
15	3/16 Int. Star Washer (2 required)	34-18	0.57
16	Valve Assembly	34	24.61

17	Base Casting	45-19	\$54.69
18	Cover Casting	45-20	51.27
19	Knob, 1" dia., 1/4-20 thread	SV-3421	3.77
20	Lever, with stop pin	34-22	14.77
21	10-32 x 5/8 Screw (2 required)	34-13	1.15
22	3/16 Washer (2 required)	34-18-3	0.57
23	3/16 x 3/4 Rollpin	45-23	2.46
24	10-32 x 1 Screw (2 required)	45-24	0.98
16	Valve Assembly	34	24.61

# AIR ACCESSORIES . . . double-acting

heinrich

Index No.	Part Name	Part No.	Price
1	Adapter (3 required)	33-16	\$3.61
2	Valve Body	45-2	27.35
3	Inlet Spring (2 required) (light)	34-3	1.56
4	Poppet (4 required)	34-4	1.64
5	Brass Pin (2 required)	34-5	1.64
6	Brass Slug for Backing Poppet (4 required)	34-6	0.98
7	Outlet Plunger Spring (2 required) (heavy)	34-7	3.28
8	Plunger (2 required)	45-8	3.94
9	1/4-18 Socket Pipe Plug (2 required)	45-9	1.64
10	1/4 x 5/8 Rollpin	45-10	1.64

REPAIR KIT FOR NO. 45 AIR VALVE ASSEMBLY,  
CONSISTING OF INDEX NUMBERS 3 thru 8

RK-45

It is recommended that a repair kit be retained in stock at all times to support the valve in service. The kit price represents a 16% savings off the individual piece prices.

11	Foot Treadle Casting -- Top	45-15	\$41.02
12	Foot Treadle Casting -- Bottom	45-16	42.73
13	Roller	45-17	6.56
14	5/16 x 3 1/4 Rollpin	34-11	1.89
15	3/16 x 3/4 Dowel	45-23	2.46
16	10-32 x 5/8 Screw (2 required)	34-13	1.15
17	3/16 Int. Star Washer (2 required)	34-18	0.57
18	Valve Assembly	45	51.96
19	1/4-28 x 1/2 Screw	45-26	1.72

18	Valve Assembly	45	\$51.96
19	Base Casting	45-19	54.69
20	Cover Casting	45-20	51.27
21	Knob, 1" dia., 1/4-20 thread	SV-3421	
22	Lever	45-22	14.77
23	3/16 x 3/4 Dowel	45-23	2.46
24	10-32 x 1 Screw (2 required)	45-24	0.98
25	10-32 x 5/8 Screw (2 required)	34-13	1.15
26	3/16 Washer	34-18-3	0.57
27	10-32 x 3/4 Screw (not shown)	45-27	1.15
28	10-32 x 3/8 Screw (not shown)	45-25	2.79

## NO. 45 FOUR-WAY AIR VALVE ASSEMBLY -

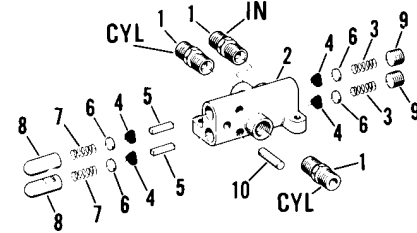

## NO. 45-12CI FOUR-WAY FOOT TREADLE VALVE ASSEMBLY -

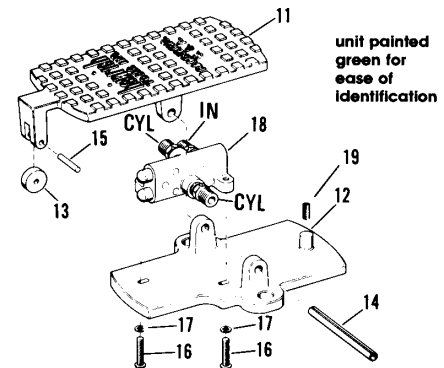

## NO. 45-18 FOUR-WAY HAND VALVE ASSEMBLY

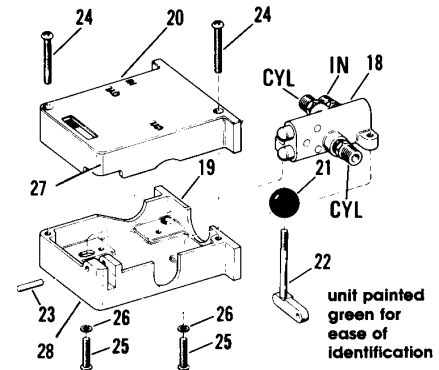

### MAINTENANCE:

If the No. 45 Four-Way Air Valve becomes inoperable, disassemble, clean and check each part for wear or damage, especially the seats in the valve body. Replacement parts are available for immediate shipment from factory stock, or you may order through your local Heinrich distributor. When re-assembling, all parts must be placed in the order as shown in the exploded view.

### OPERATION:

Slotted holes are provided in the foot or hand base castings so that the position of the valve on the base may be adjusted. The valve should be so positioned that air does not escape in either open or closed position. This can be determined by the sound of air escaping. Mounting screws should be securely fastened after adjustment.

The plungers (8) on the valve should be greased occasionally.